

Nylon Metric Screws

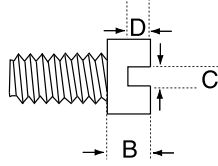
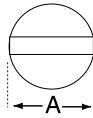

Nylon Metric Slotted Cheese Head

THREAD SIZE	A	B	C	D
M6 X 1.0	10.00	3.90	1.90	2.30

Code #	Description
M66CHNN	M6 X 1.00 X 6 MM
M68CHNN	M6 X 1.00 X 8 MM
M610CHNN	M6 X 1.00 X 10 MM
M612CHNN	M6 X 1.00 X 12 MM

Code #	Description
M616CHNN	M6 X 1.00 X 16 MM
M620CHNN	M6 X 1.00 X 20 MM
M625CHNN	M6 X 1.00 X 25 MM
M630CHNN	M6 X 1.00 X 30 MM

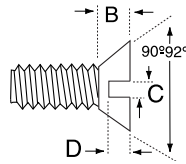
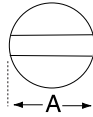
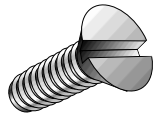

Nylon Metric Slotted Flat Machine

THREAD SIZE	A	B	C	D
M5 X 0.8	9.20	2.50	1.40	1.20

Code #	Description
M5810FLAT	M5 X .8 X 10 MM
M5813FLAT	M5 X .8 X 13 MM

Code #	Description
M5815FLAT	M5 X .8 X 15 MM
M5820FLAT	M5 X .8 X 20 MM

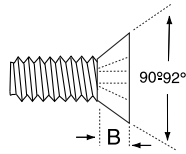
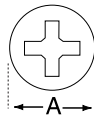

Nylon Metric Phillips Flat Machine

THREAD SIZE	A	B
M4 X 0.7	7.50	2.20

Code #	Description
M476PHF	M4 X .7 X 6 MM

Code #	Description
M4710PHF	M4 X .7 X 10 MM

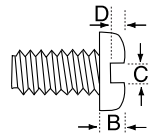
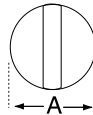
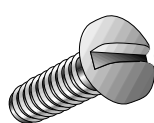

Nylon Metric Slotted Pan

THREAD SIZE	A	B	C	D
M4 X 0.7	7.00	2.80	1.30	1.15
M6 X 1.0	12.00	4.00	1.70	1.70

Code #	Description
M476P	M4 X .7 X 6 MM
M478P	M4 X .7 X 8 MM
M4710P	M4 X .7 X 10 MM
M4712P	M4 X .7 X 12 MM
M4716P	M4 X .7 X 16 MM
M4720P	M4 X .7 X 20 MM
M4725P	M4 X .7 X 25 MM
M616P	M6 X 1 X 6 MM

Code #	Description
M618P	M6 X 1 X 8 MM
M6110P	M6 X 1 X 10 MM
M6112P	M6 X 1 X 12 MM
M6116P	M6 X 1 X 16 MM
M6120P	M6 X 1 X 20 MM
M6125P	M6 X 1 X 25 MM
M6130P	M6 X 1 X 30 MM