

TOOTHED PERIPHERY CONICAL WASHERS

| Hole Size | Inside Diameter | | Outside Diameter | | Free Height | | Thickness | WCL Product Number |
|-----------|-----------------|------|------------------|-------|-------------|------|-----------|--------------------|
| | Min. | Max. | Min. | Max. | Min. | Max. | | |
| 10 | .195 | .200 | .400 | .410 | .054 | .070 | .035 | 3531-10-02 |
| 10 | .195 | .200 | .620 | .630 | .080 | .090 | .050 | C-102050-1 |
| 7/16 | .446 | .460 | .990 | 1.010 | .138 | .158 | .113 | 3531-22-02 |
| 1/2 | .515 | .530 | 1.240 | 1.260 | .205 | .215 | .118 | 3531-24-01 |

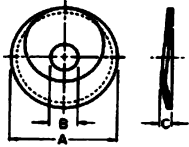

RAMP CONICAL WASHERS™

| Hole Size | Inside Diameter | | Outside Diameter | | Free Height | | Thickness | WCL Product Number |
|-----------|-----------------|------|------------------|-------|-------------|------|-----------|--------------------|
| | Min. | Max. | Min. | Max. | Min. | Max. | | |
| 6 | .142 | .150 | .307 | .317 | .033 | .039 | .022 | 3533-06-02 |
| 10 | .195 | .204 | .433 | .443 | .046 | .052 | .029 | 3533-10-02 |
| 10 | .195 | .204 | .433 | .443 | .062 | .068 | .045 | 3533-10-06 |
| 12 | .221 | .231 | .433 | .443 | .049 | .055 | .029 | 3533-12-02 |
| 1/4 | .256 | .267 | .495 | .505 | .063 | .071 | .039 | 3533-14-02 |
| 1/4 | .256 | .267 | .740 | .760 | .073 | .083 | .039 | 3533-14-03 |
| 1/4 | .256 | .267 | .495 | .505 | .079 | .087 | .055 | 3533-14-06 |
| 1/4 | .256 | .267 | .740 | .760 | .089 | .099 | .055 | 3533-14-07 |
| 5/16 | .320 | .332 | .615 | .635 | .072 | .080 | .043 | 3533-18-02 |
| 5/16 | .320 | .332 | .865 | .885 | .088 | .098 | .045 | 3533-18-03 |
| 5/16 | .320 | .332 | .865 | .885 | .105 | .115 | .082 | 3533-14-07 |
| 3/8 | .384 | .398 | .740 | .760 | .086 | .094 | .050 | 3533-20-02 |
| 3/8 | .384 | .398 | .990 | 1.010 | .120 | .130 | .070 | 3533-20-07 |
| 7/16 | .448 | .463 | 1.115 | 1.135 | .160 | .170 | .093 | 3533-22-07 |
| 1/2 | .515 | .525 | 1.240 | 1.260 | .190 | .200 | .109 | 3533-24-07 |
| 1/2 | .512 | .529 | 1.240 | 1.260 | .174 | .184 | .093 | 3533-24-12 |
| 1/2 | .515 | .525 | 1.115 | 1.135 | .165 | .175 | .093 | 3533-24-13 |
| 5/8 | .650 | .660 | 1.385 | 1.385 | .133 | .153 | .083 | 3533-28-11 |
| 5/8 | .640 | .655 | 1.490 | 1.510 | .221 | .233 | .125 | 3533-24-12 |

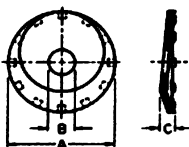

RAMP CONICAL™ TOOTH PERIPHERY

| Hole Size | Inside Diameter | | Outside Diameter | | Free Height | | Thickness | WCL Product Number |
|-----------|-----------------|------|------------------|-------|-------------|------|-----------|--------------------|
| | Min. | Max. | Min. | Max. | Min. | Max. | | |
| 3/8 | .384 | .398 | .865 | .885 | .100 | .110 | .045 | 3534-20-11 |
| 3/8 | .390 | .395 | .990 | 1.010 | .120 | .130 | .070 | 3534-20-07 |