



National Aerospace Fasteners Corp.



NH-M *SERIES*

TURE METRIC

HALF HEX SHANK & SLIM HEAD

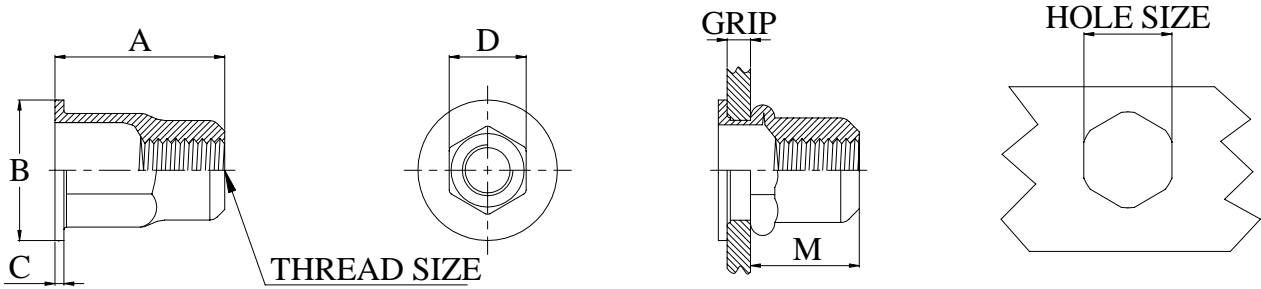

DIMENSIONS

Unit: mm

THREAD SIZE	PART NUMBER.	GRIP RANGE		A	B		C	D	M	HOLE SIZE
		Min.	Max.	Nom.	Min.	Max.	± 0.13	± 0.08	Ref.	+0.10 ~ -0.00
M4X0.7	NHS-470M-2.0	0.50	2.00	10.5	8.75	9.25	1.0	5.89	6.5	6.0
M5X0.8	NHS-580M-3.0	0.50	3.00	13.2	9.75	10.25	1.0	6.89	8.2	7.0
M6X1.0	NHS-610M-3.0	0.50	3.00	15.5	12.75	13.25	1.5	8.89	10.5	9.0
M8X1.25	NHS-8125M-3.0	0.70	3.00	18.0	15.60	16.40	1.5	10.89	12.5	11.0
M10X1.5	NHS-1015M-3.5	1.00	3.50	21.0	18.60	19.40	2.0	12.89	15.0	13.0
M12X1.75	NHS-12175M-4.5	1.50	4.50	27.5	22.50	23.50	2.25	14.89	18.0	15.0

*Other sizes, threads and grip ranges are available on request

TEST METHOD

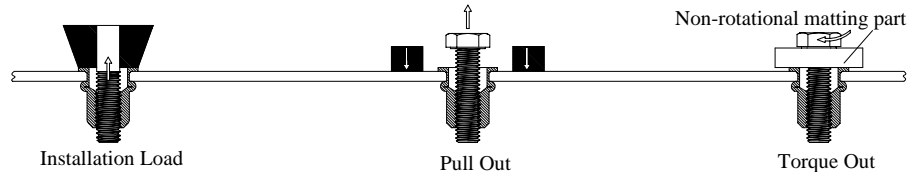

Engineering Data

Thread Size	Installation Load (K-N)		*Pull Out (K-N)	**Torque Out (N-m)
	Min grip	Max grip		
M4X0.7	4.05	5.80	6.9	6.5
M5X0.8	5.10	7.20	10.2	9.0
M6X1.0	7.65	11.50	16.5	18.0
M8X1.25	9.20	14.70	24.0	35.0
M10X1.5	11.85	19.60	32.0	54.0
M12X1.75	19.65	24.50	45.0	70.0

- * Pull Out is the force required to pull the NAFCO product from the parent material.
- ** Torque Out is the maximum recommended torque to be applied to the bolt (class 8.8/9.8), which will not cause thread distortion in the insert.
- *** These values are averages only- certain variations must be expected in actual application. NAFCO recommends that these values be used only as a guide.

Fastener Specifications:

Material: Steel 1008, 1010, or Equiv. Per SAE J403f
 Finish: Zinc Plated, Yellow Chromate
 Per ASTM B633 Fe/Zn 8, Type II
 (Special Material and Plating also Available on Request)

Part Number Explanation:

Example: NHS-610M-3.0

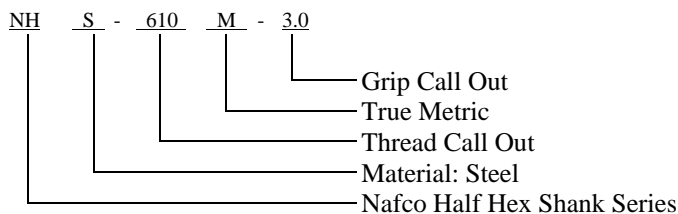

NH-M-L

TRUE METRIC HALF HEX SHANK SLIM HEAD SERIES

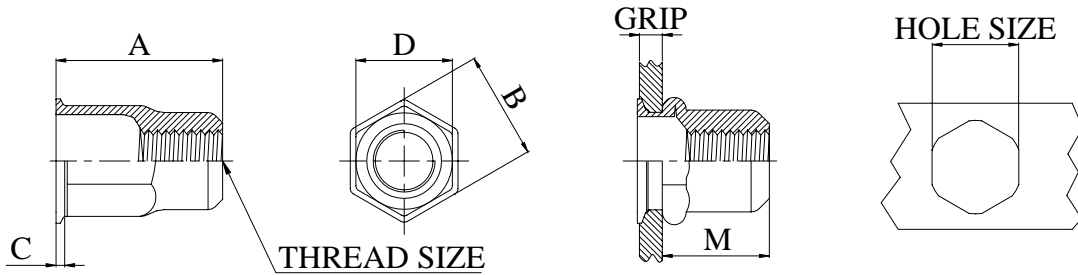

DIMENSIONS

Unit: mm

THREAD SIZE	PART NUMBER	GRIP RANGE		A	B		C	D	M	HOLE SIZE
		Min.	Max.	Nom.	Min.	Max.	±0.13	±0.08	Ref.	+0.10 ~ -0.00
M4X0.7	NHS-470M-2.0L	0.50	2.00	10.2	6.58	6.88	0.67	5.89	6.5	6.0
M5X0.8	NHS-580M-3.0L	0.50	3.00	13.0	7.72	8.07	0.77	6.89	8.2	7.0
M6X1.0	NHS-610M-3.0L	0.50	3.00	15.0	9.75	10.10	0.87	8.89	10.5	9.0
M8X1.25	NHS-8125M-3.0L	0.70	3.00	17.5	11.90	12.25	0.97	10.89	12.5	11.0

*Other sizes, threads and grip ranges are available on request

TEST METHOD

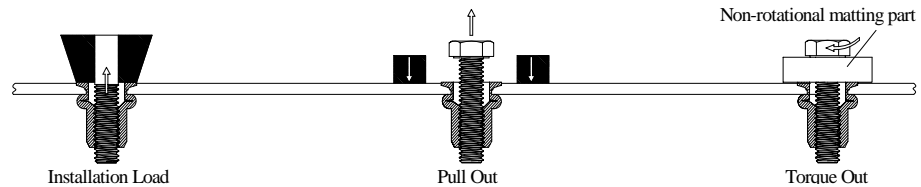

Engineering Data

Thread Size	Installation Load (K-N)		*Pull Out (K-N)	**Torque Out (N-m)
	Min grip	Max grip		
M4X0.7	4.00	5.75	6.9	6.5
M5X0.8	5.05	7.10	10.2	9.0
M6X1.0	7.55	11.25	16.5	18.0
M8X1.25	9.10	14.20	24.0	35.0

- * **Pull Out** is the force required to pull the NAFCO product from the parent material.
- ** **Torque Out** is the maximum recommended torque to be applied to the bolt (class 8.8/9.8), which will not cause thread distortion in the insert.
- *** These values are averages only- certain variations must be expected in actual application. NAFCO recommends that these values be used only as a guide.

Fastener Specifications

Material: Steel 1008, 1010, or Equiv. Per SAE J403f
 Finish: Zinc Plated, Yellow Chromate
 Per ASTM B633 Fe/Zn 8, Type
 (Special Material and Plating also Available on Request)

Part Number Explanation:

Example: NHS-470M-2.0L

