



National Aerospace Fasteners Corp.



NF -M *SERIES*

*TURE METRIC*

*FULL HEX SHANK & SLIM HEAD*

# NF-M

## TRUE METRIC FULL HEX SHANK SERIES

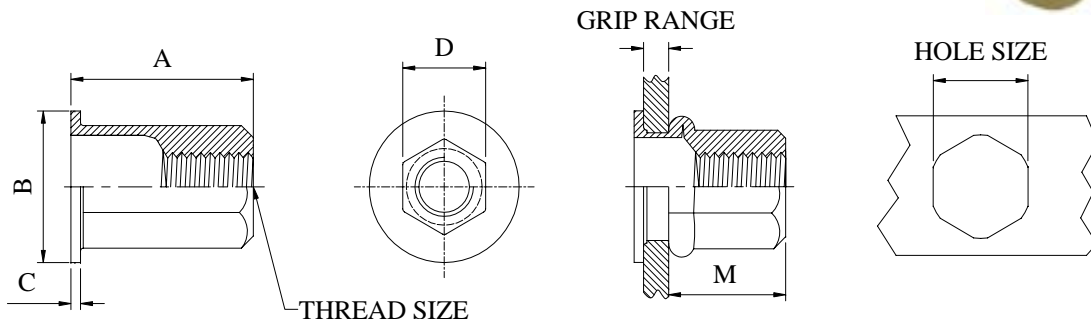

### DIMENSIONS

Unit: mm

THREAD SIZE	PART NUMBER	GRIP RANGE		A Nom.	B		C ± 0.13	D ± 0.08	M Ref.	HOLE SIZE +0.10 ~ -0.00
		Min	Max		Min.	Max.				
M4X0.7	NFS-470M-2.0	0.50	2.00	11.0	8.75	9.25	1.0	5.89	6.5	6.0
M5X0.8	NFS-580M-3.0	0.50	3.00	14.0	9.75	10.25	1.0	6.89	9.0	7.0
M6X1.0	NFS-610M-3.0	0.50	3.00	16.0	12.75	13.25	1.5	8.89	11.0	9.0
M8X1.25	NFS-8125M-3.0	0.70	3.00	18.0	15.60	16.40	1.5	10.89	12.5	11.0

\*Other sizes, threads and grip ranges are available on request

### TEST METHOD

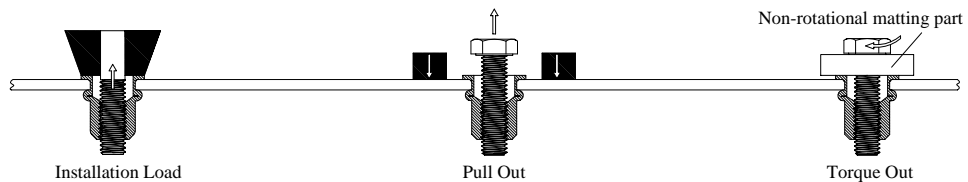

### Engineering Data

Thread Size	Installation Load (K-N)		Pull Out* (K-N)	Torque Out ** (N-m)
	Min grip	Max grip		
M4X0.7	4.05	5.80	6.9	7.0
M5X0.8	5.10	7.20	10.2	9.5
M6X1.0	7.65	11.50	16.5	18.5
M8X1.25	9.20	15.10	24.0	36.0

- \* **Pull Out** is the force required to pull the NAFCO product from the parent material.
- \*\* **Torque Out** is the maximum recommended torque to be applied to the bolt (class 8.8/9.8), which will not cause thread distortion in the insert.
- \*\*\* These values are averages only- certain variations must be expected in actual application. NAFCO recommends that these values be used only as a guide.

### Fastener Specifications

Material: Steel 1008, 1010, or Equiv Per SAE J403f  
 Finish: Zinc Plated, Yellow Chromate  
 Per ASTM B633 Fe/Zn 8, Type II  
 (Special Material and Plating also Available on Request)

### Part Number Explanation

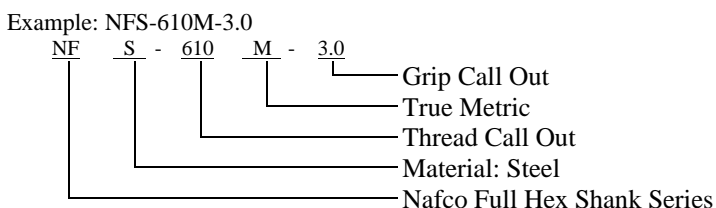

# NF-M-L



## TRUE METRIC FULL HEX SHANK SLIM HEAD SERIES

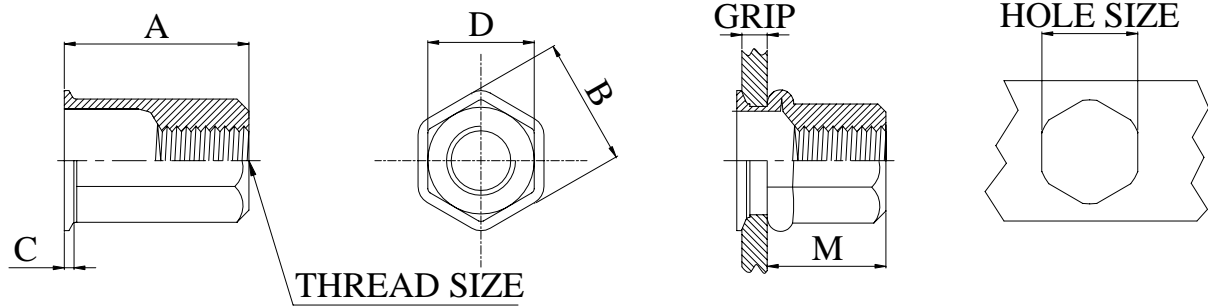

### DIMENSIONS

Unit: mm

THREAD SIZE	PART NUMBER	GRIP RANGE		A	B		C	D	M	HOLE SIZE
		Min.	Max.	Nom.	Min.	Max.	± 0.13	Max.	Ref.	+0.10/-0.00
M4X0.7	NFS-470M-2.0L	0.50	2.00	10.5	6.58	6.88	0.67	5.89	6.5	6.0
M5X0.8	NFS-580M-3.0L	0.50	3.00	14.0	7.72	8.07	0.77	6.89	9.0	7.0
M6X1.0	NFS-610M-3.0L	0.50	3.00	16.0	9.75	10.10	0.87	8.89	11.0	9.0
M8X1.25	NFS-8125M-3.0L	0.70	3.00	18.0	11.90	12.25	0.97	10.89	12.5	11.0

\*Other sizes, threads and grip ranges are available on request

### TEST METHOD

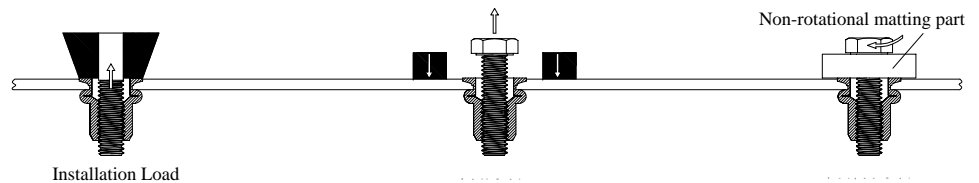

### Engineering Data

Thread Size	Installation Load (KN)		Pull Out* (KN)	Torque Out** (N-m)
	Min grip	Max grip		
M4X0.7	4.00	5.75	6.9	7.0
M5X0.8	5.05	7.10	10.2	9.5
M6X1.0	7.55	11.25	16.5	18.5
M8X1.25	9.10	14.70	24.0	36.0

- \* **Pull Out** is the force required to pull the NAFCO product from the parent material.
- \*\* **Torque Out** is the maximum recommended torque to be applied to the bolt (class 8.8/9.8), which will not cause thread distortion in the insert.
- \*\*\* These values are averages only- certain variations must be expected in actual application. NAFCO recommends that these values be used only as a guide.

### Fastener Specifications:

Material: Steel 1008, 1010, or Equiv. Per SAE J403f  
 Finish: Zinc Plated, Yellow Chromate  
 Per ASTM B633 Fe/Zn 8, Type II  
 (Special Material and Plating also Available on Request)

### Part Number Explanation:

Example: NFS-470M-2.0L

