

PC Light Standoffs

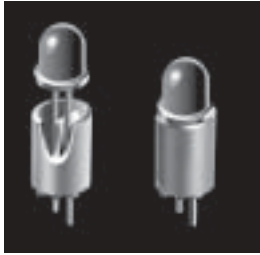

T-1 and T-13/4

Designed for mounting LEDs, resistors, capacitors, transistors and diodes on printed circuit boards. Eliminates or controls problems of mounting passive components on PC boards, including height control, lead shorting and removal of soldering residue.

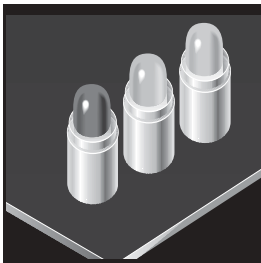

PC Standoff design has a cylindrical plastic body, dual-tapered lead entry ports, center barrier for lead separation and raised clearance pads for proper cleansing of the PCB. The cylindrical body protects the leads from damage by outside agencies while its center barrier prevents the possible shorting of the component leads.

Installation

Standoff has dual tapered entry ports on .100 inch centers. This permits installation of varied shapes of LEDs and other opto-components.

Component elevation is simplified, with mounts available in heights varying from .100 to .990 in increments of .010 of an inch.

BARRIER HEIGHT

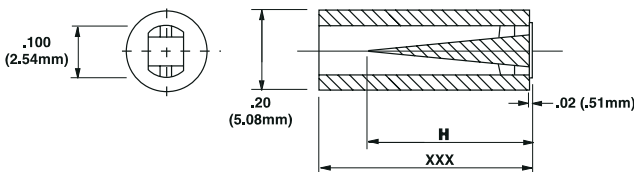

LENGTH = XXX

- .120" TO .240"
- .250" TO .360"
- .370" TO .480"
- .490" TO .640"
- .650" TO .740"
- .750" TO .990"

BARRIER = H

- .08"
- .20"
- .33"
- .45"
- .58"
- .70"

SPECIFICATIONS MATERIAL:

Molded From U.L. Rated 94V-2 Nylon (Natural).

DESIGN:

Has center barrier for lead separation. Tapered entry holes simplify lead insertion. Raised pads for board cleaning.

MOUNTING:

Passive components, LEDs resistors, capacitors, diodes. Standoffs vary in height from .100 minimum to .990 inch maximum increments of .010 inch.

ORDER CODE

PART

275 - (Series with ID .133")

175 - (Series with ID .155")

STD XXX LENGTH IN INCHES

	200	300	400	500	600	700	800	900
	210	310	410	510	610	710	810	910
120	220	320	420	520	620	720	820	920
130	230	330	430	530	630	730	830	930
140	240	340	440	540	640	740	840	940
150	250	350	450	550	650	750	850	950
160	260	360	460	560	660	760	860	960
170	270	370	470	570	670	770	870	970
180	280	380	480	580	680	780	880	980
190	290	390	490	590	690	790	890	990