

Printed Circuit Board Supports



Dual Locking Circuit Board Supports

- Both ends lock by hand; no tools required
- Strong, dependable grip
- Available in three styles: Standard material molded from U.L. Rated 94V-2 nylon (Natural) or flame retardant nylon rated 94V-0 (Off-White)

When Ordering Specify Style A, B, or C.

EXAMPLE:

For 3/16" Length 94V-2 Support with .156" Board Hole and .187" Chassis Hole order: 515-187C

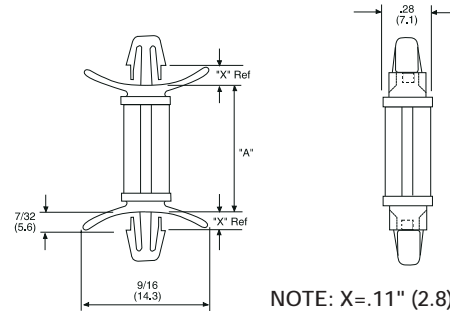

NOTE: X=.11" (2.8)

STYLE	BOARD HOLE DIA.	CHASSIS HOLE DIA.
A	.156" (4.0)	.156" (4.0)
B	.187" (4.8)	.187" (4.8)
C	.156" (4.0)	.187" (4.8)

PART #		"A"
94V--2 Nylon	94V-0 Nylon	INCHES (MM)
515-187	516-187	3/16" (4.8)
515-250	516-250	1/4" (6.4)
515-375	516-375	3/8" (9.5)
515-500	516-500	1/2" (12.7)
515-625	516-625	5/8" (15.9)
515-750	516-750	3/4" (19.1)
515-875	516-875	7/8" (22.2)



Locking Circuit Board Supports

- Both ends lock by hand
- No tools required
- Releasable for repairs
- Standard material molded from U.L. Rated 4V-2 nylon (natural) or flame retardant nylon rated 94V-0 (off-white)

NOTE: X=.11" (2.8) (1/8")
X= .18" (4.6)

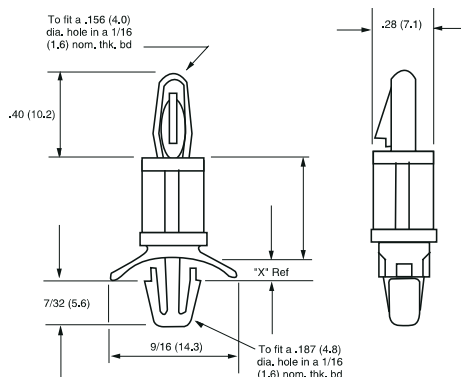

PART # 94V-2 Nylon	PART # Flame Retardant 94V-0	"A" INCHES (MM)
335-187	336-187	3/16" (4.8)
335-250	336-250	1/4" (6.4)
335-312	336-312	5/16" (7.1)
335-375	336-375	3/8" (9.5)
335-438	336-438	7/16" (11.1)
335-500	336-500	1/2" (12.7)
335-625	336-625	5/8" (15.9)
335-750	336-750	3/4" (19.1)
335-875	336-875	7/8" (22.2)
335-1000	336-1000	1" (25.4)
335-1125	336-1125	1"-1/8" (28.6)
335-1250	336-1250	1"-1/4" (31.8)
335-1375	336-1375	1"-3/8" (34.9)