

Nylon Printed Circuit Board Posts

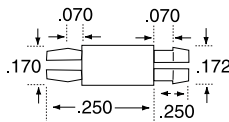
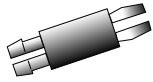

- * Fits .093 hole size.
- * Locking spacer eliminates other hardware in mounting P.C. Boards on metal chassis or stacking in tiers.

Nylon Printed Circuit Board Posts

Code #
Description

PCBP250

Printed Circuit Board Post .250

Nylon Wire and Cable Holders

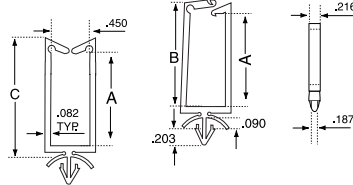

Nylon Wire and Cable Holders "Top Entry"

Gather and direct a single or group of cables at low cost. Vertical orientation for top entry and narrow width.
 Regular gate secures cables with tension alone - Latch gate locks cables securely.
 Both types install with fingertip pressure into a 3/16" (4.8mm) diameter hole.
 Bayonet mount self-adjusts to various thickness up to .090 (2.3mm).

| Code # | Description | A | | B | | C | |
|--------|--------------|-------|------|-------|------|-------|------|
| | | In. | Mm. | In. | Mm. | In. | Mm. |
| CHR12 | Regular Gate | .171 | 4.4 | .343 | 8.7 | .484 | 12.3 |
| CHR18 | Regular Gate | .390 | 9.9 | .575 | 14.7 | .718 | 18.2 |
| CHR27 | Regular Gate | .750 | 19.0 | .937 | 23.8 | 1.062 | 27.0 |
| CHR35 | Regular Gate | 1.062 | 27.0 | 1.250 | 31.7 | 1.375 | 35.0 |
| CHL12 | Latch Gate | .140 | 3.6 | .343 | 8.7 | .484 | 12.3 |
| CHL18 | Latch Gate | .360 | 9.1 | .578 | 14.7 | .718 | 18.2 |
| CHL27 | Latch Gate | .718 | 18.2 | .937 | 23.8 | 1.000 | 27.0 |
| CHL35 | Latch Gate | 1.031 | 26.2 | 1.250 | 31.7 | 1.375 | 35.0 |

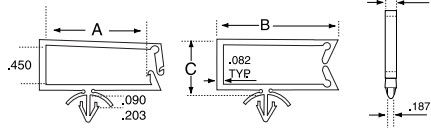
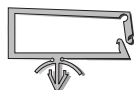

Nylon Wire and Cable Holders "Side Entry"

Horizontal orientation for side entry and low height where clearance is a problem.
 Installs with fingertip pressure into a 3/16" (4.8mm) diameter hole.
 Bayonet mount self-adjusts to various thickness up to .090 (2.3mm).

| Code # | Description | A | | B | | C | |
|---------|-------------|------|------|-------|------|------|------|
| | | In. | Mm. | In. | Mm. | In. | Mm. |
| CHL2790 | Latch Gate | .718 | 18.2 | 1.050 | 23.4 | .665 | 16.7 |