

BUMPERS

DOMED HEAD SPLIT STEM BUMPERS

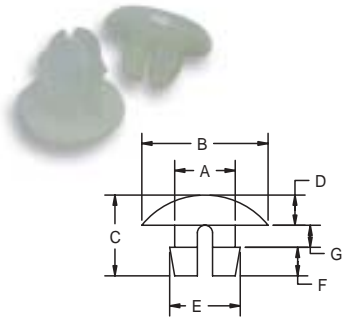

PART NUMBER	TO FIT HOLE	A (IN.)	B (IN.)	C (IN.)	D (IN.)	E (IN.)	F (IN.)	G (IN.)	STEM STYLE	HEAD STYLE
138NN-5324-0000	0.125	0.109	0.250	0.203	0.093	0.125	0.046	0.063	I	A
138NN-5500-0000	0.125	0.125	0.375	0.307	0.046	0.150	0.130	0.130	II	A
138NN-5426-0000	0.156	0.152	0.375	0.265	0.093	0.172	0.094	0.085	II	B
138NN-5300-0000	0.156	0.156	0.375	0.265	0.093	0.173	0.093	0.093	II	B
138NN-5320-0000	0.187	0.187	0.343	0.191	0.043	0.218	0.092	0.066	II	B
138NN-5327-0000	0.187	0.187	0.390	0.250	0.093	0.218	0.088	0.068	II	B
138NN-5310-0000	0.218	0.210	0.375	0.343	0.063	0.243	0.125	0.156	II	B

SPECIFICATIONS

- Standard Color: Natural
- Standard Material: Nylon

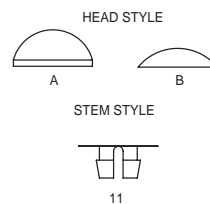

138 Series

Domed Head Split Stem Bumpers are produced with a split stem portion to make insertion easy and removal difficult. The domed head makes them ideal for use as bumpers.

BUTTON STEM BUMPERS

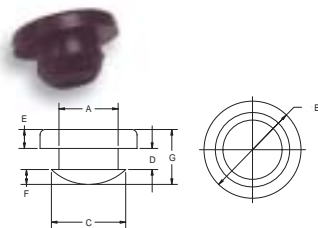

PART NUMBER	A (IN.)	B (IN.)	C (IN.)	D (IN.)	E (IN.)	F (IN.)	G (IN.)	MATERIAL	COLOR
138PB-5357-0000	0.219	0.359	0.225	0.078	0.07	0.055	0.187	POLYETHYLENE	BLACK

SPECIFICATIONS

- Standard Color: Black
- Standard Material: Polyethylene

138 Series

Button Stem Bumpers are designed for insertion into holes in sheet metal or metal tubing.

COVERED STEM BUMPERS

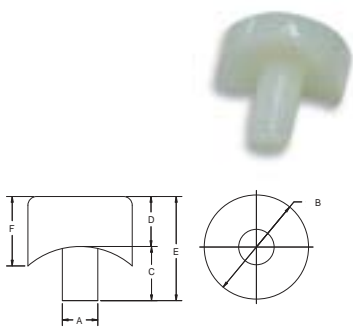

PART NUMBER	TO FIT HOLE	A (IN.)	B (IN.)	C (IN.)	D (IN.)	E (IN.)	F (IN.)	LEAD STYLE	MATERIAL	COLOR
138PB-5401-0000	0.562	0.250	0.500	0.281	0.156	0.437	0.187	N	POLY.	BLACK
138NN-5304-0000	0.686	0.250	0.750	0.375	0.187	0.562	0.437	T	NYLON	NATURAL
138NN-3309-000A	1.000	0.255	0.750	0.543	0.187	0.360	0.500	T	NYLON	NATURAL
138PB-5463-0000	1.000	0.257	0.750	0.290	0.210	0.500	0.361	S	POLY.	BLACK

SPECIFICATIONS

- Standard Color: See Chart
- Standard Material: See Chart

138 Series

Molded with an inside radius; suitable for seating of the part on the round tubing. The stem portion provides the press fit required for fastening. Used exclusively as protective devices and glides.



WEDGE STEM BUMPERS

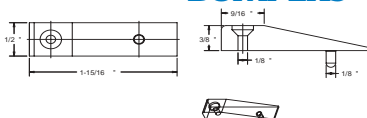

PART NUMBER	MATERIAL	COLOR
169PB-0312-0000	POLYETHYLENE	BLACK

SPECIFICATIONS

- Standard Color: Black
- Standard Material: Polyethylene

169 Series

Secured with a screw, the bumper is ideal for applications needing extra strength.