

PANEL FASTENERS/SCREW GROMMETS

PLASTI-GROMMETS™

One-piece, non-corrosive nylon, self-retaining blind screw receptacles spread loads over wide area for strength and high load bearing capacity. Front snap in. Insulate at fastening points, protect against electrolytic action, eliminate cross threading.

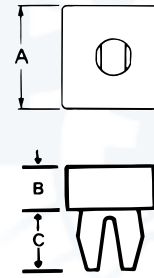

PART NUMBER	PANEL HOLE SIZE*	PANEL THICKNESS RANGE	SCREW SIZE	HEAD SIZE A	HEAD HEIGHT B	PRONG LENGTH C
242-160502-70	.245-.255 SQ.	.031-.125	6 or 8	.365-.385 SQ.	.028-.033	.266-.296
242-170602-80	.265-.281 SQ.	.031-.156	8	.365-.385 SQ.	.030-.035	.310-.340
242-170602-81	.265-.281 SQ.	.031-.156	8	.365-.385 SQ.	.030-.035	.310-.340
242-170602-83	.265-.286 SQ.	.031-.140	6 or 8	.365-.385 SQ.	.030-.040	.315-.335
242-170602-82	.275-.281 SQ.	.031-.156	8	.365-.385 SQ.	.030-.035	.310-.340
242-170602-84	.275-.290 SQ.	.031-.156	8	.365-.385 SQ.	.030-.040	.310-.340
242-180602-90	.275-.290 SQ.	.031-.156	8 or 10	.396-.416 SQ.	.028-.038	.310-.340
242-180602-91	.275-.290 SQ.	.031-.156	8 or 10	.396-.416 SQ.	.057-.067	.310-.340
242-180602-92	.275-.290 SQ.	.031-.156	8 or 10	.490-.510 DIA.	.093-.103	.310-.340
242-180602-93	.275-.290 SQ.	.031-.156	8 or 10	.490-.510 DIA.	.125-.135	.310-.340
242-210602-10	.330-.343 SQ.	.031-.156	1/4"	.552-.572 DIA.	.057-.067	.310-.340
212-110302-00	.173-.178 SQ.	.031-.078	4	.208-.228 SQ.	.045-.055	.208-.228
212-160404-08	.250-.255 SQ.	.031-.109	6	.360-.390 SQ.	.183-.193	.271-.291
212-170602-00	.265-.281 SQ.	.031-.156	8 or 10	.485-.515 x .735-.765 RECT	.035-.045	.310-.340
212-170602-05	.270-.275 SQ.	.031-.109	8 or 10	.485-.515 DIA.	1.360-1.390	.266-.296
212-180402-06	.270-.275 SQ.	.031-.109	8 or 10	.391-.421 SQ.	.025-.035	.266-.296
212-180402-66	.270-.275 SQ.	.031-.109	8 or 10	.485-.515 DIA.	.245-.255	.266-.296
212-180402-91	.270-.275 SQ.	.031-.109	6	.365-.385 SQ.	.302-.307	.266-.296
212-170402-01	.270-.275 SQ.	.031-.109	8 or 10	.365-.385 DIA.	.662-.682	.266-.296
212-180402-11	.270-.275 SQ.	.031-.109	8 or 10	.557-.567 DIA.	.557-.567	.266-.296
212-180402-73	.270-.275 SQ.	.031-.109	8 or 10	.485-.515 DIA.	.927-.947	.266-.296
212-180602-10	.281-.286 SQ.	.031-.156	8 or 10	.360-.390 SQ.	.040-.050	.329-.359
212-180602-13	.275-.290 SQ.	.031-.156	8 or 10	.485-.515 DIA.	.360-.390	.310-.340
212-170602-37	.275-.290 SQ.	.031-.156	8	.490-.510 DIA.	.490-.510	.310-.340
212-180402-55	.281-.286 SQ.	.031-.109	8 or 10	.485-.515 SQ.	.120-.130	.266-.296
212-180402-15	.281-.286 SQ.	.031-.109	8 or 10	.485-.515 DIA.	.240-.260	.266-.296
212-180402-69	.281-.286 SQ.	.031-.109	8 or 10	.485-.515 DIA.	.307-.317	.266-.296
212-180402-40	.281-.286 SQ.	.031-.109	8 or 10	.485-.500 DIA.	.360-.390	.266-.296
212-180402-38	.281-.286 SQ.	.031-.109	8 or 10	.485-.500 DIA.	.485-.515	.266-.296
212-180402-37	.281-.286 SQ.	.031-.093	8 or 10	.485-.500 DIA.	.610-.640	.266-.296
212-180402-51	.281-.286 SQ.	.031-.109	8 or 10	.485-.500 DIA.	.672-.702	.266-.296
212-180402-53	.281-.286 SQ.	.031-.109	8 or 10	.485-.500 DIA.	.735-.765	.266-.296
212-180402-83	.281-.286 SQ.	.031-.109	8 or 10	.532-.562 DIA.	1.047-1.077	.266-.296
212-240602-04	.370-.380 SQ.	.031-.156	1/4"	.610-.640 SQ.	.073-.083	.329-.359
212-240402-07	.375-.390 SQ.	.031-.156	1/4"	.672-.702 DIA.	.360-.390	.310-.340
212-240402-00	.375-.380 SQ.	.031-.109	1/4"	.610-.640 SQ.	.073-.083	.276-.286
212-240602-00	.375-.380 SQ.	.031-.156	1/4"	.672-.702 DIA.	.454-.484	.329-.359
212-240402-04	.375-.390 SQ.	.031-.156	10	.610-.640 SQ.	.063-.093	.310-.340
212-270402-01	.425-.430 SQ.	.031-.109	5/16"	.547-.577 SQ.	.063-.093	.297-.327

NOTE: Dimensions listed are nominal.