

FASTENER PROTECTION

PART NUMBER	TO FIT SCREW SIZES	A	B	C	BOX QTY*
USC-6810	6 TO 12	.114	.154	.539	8,000

* Molded in sets of 12 on spine.

SPECIFICATIONS

- Standard Color: White
- Standard Material: Polypropylene
- Consult factory for availability of optional colors; minimum order requirements may apply

USC Series

The USC Series fits a range of screw sizes, reducing the need to inventory a wide variety of caps. Each cap will take a No. 6, 8 or 10 flat head, oval head or No. 6 round head screw.

UNISCREW CAPS

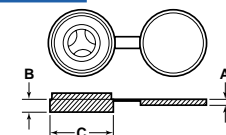
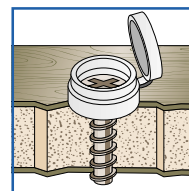

PART NUMBER	DIMENSIONS TO FIT BOLT SIZE	A	BOX QTY
BNC-0250	1/4	.437	5,000
BNC-0437	7/16	.622	2,500
BNC-0500	1/2	.740	2,000
BNC-0625	5/8	.937	1,000

SPECIFICATIONS

- Standard Colors: Black ("B"); White ("W").
- To order, please use appropriate suffix Part No. (e.g. BCN00250B or BCN0250W)
- Standard Material: Low Density Polyethylene

BNC Series

The BNC Series protects nuts and bolts against weathering and tampering, as well as enhances the overall appearance of your product.

BOLT & NUT PROTECTION CAPS

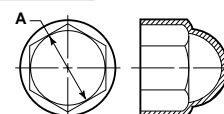
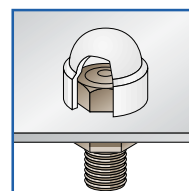

PART NUMBER	TO FIT DRIVE SIZE	BOX QTY
CHC-2	#2	20,000
CHC-3	#3	20,000
CHC-4	#4	20,000

SPECIFICATIONS

- Standard Color: White
- Standard Material: Low Density Polyethylene
- Consult factory for availability of optional colors; minimum order requirements may apply

CHC Series

The Cross-Head Screw Caps provide excellent concealment and protection of Phillips head screws.

CROSS-HEAD SCREW CAPS

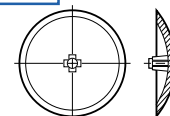
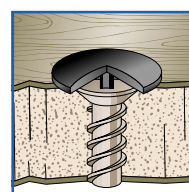

PART NUMBER	DIMENSIONS RIVET SIZE	A	B	BOX QTY
RVC-0125	1/8	0.315	0.070	10,000
RVC-0156	5/32	0.374	0.087	10,000
RVC-0187-39	3/16	0.394	0.110	10,000
RVC-0187-51	3/16	0.512	0.118	10,000
RVC-0187-63	3/16	0.630	0.106-.118	10,000

SPECIFICATIONS

- Standard Color: White
- Standard Material: Low Density Polyethylene
- Consult factory for availability of optional colors; minimum order requirements may apply

RVC Series

The RVC Series will protect and conceal the heads of most popular breakstem rivets.

RIVET CAPS

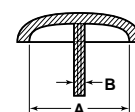
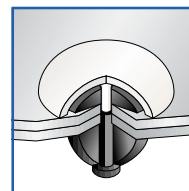

800-331-3816

www.wclco.com

FASTENER PROTECTION

LOW PROFILE DECORATIVE CAPS

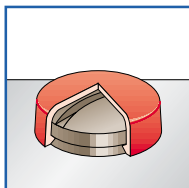

PART NUMBER	TYPE	CAP HEIGHT	TO FIT SCREW		COLOR
			INCHES	METRIC	
LPC-6103	CAP	0.150	#3	M3	ALL COLORS*
LPC-6199	WASHER	-	#3	M3	WHITE ONLY
LPC-6308	CAP	0.165	#4/#6/#8	M4	ALL COLORS*
LPC-6399	WASHER	-	#4/#6/#8	M4	WHITE ONLY
LPC-6412	CAP	0.189	#10/#12	M5	ALL COLORS*
LPC-6499	WASHER	-	#10/#12	M5	WHITE ONLY
LPC-7412	CAP	0.240	#10/#12	M5	ALL COLORS*
LPC-6499	WASHER	-	#10/#12	M5	WHITE ONLY

* See Color Selection Chart below.

SPECIFICATIONS

- Standard Material: Polypropylene with U.V. Stabilizer
- Consult factory for availability of non-stock colors, custom or metric sizes; minimum order requirements may apply

LPC Series

A simple cap and washer system for protecting, decorating or concealing exposed bolts, screws and rivets. The LPC Series is widely used in the furniture, recreational vehicle and prefabricated home industries.

HIGH PROFILE DECORATIVE CAPS

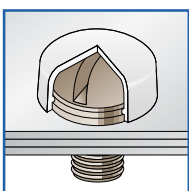

PART NUMBER	TYPE	CAP HEIGHT	TO FIT SCREW		COLOR
			INCHES	METRIC	
HPC-8205	CAP	0.187	#4/#5	M3.5	ALL COLORS*
HPC-8299	WASHER	-	#4/#5	M3.5	WHITE ONLY
HPC-8308	CAP	0.213	#6/#8	M4	ALL COLORS*
HPC-8399	WASHER	-	#6/#8	M4	WHITE ONLY
HPC-8412	CAP	0.256	#10/#12	M5	ALL COLORS*
HPC-8499	WASHER	-	#10/#12	M5	WHITE ONLY
HPC-8610	CAP	0.488	1/4	M10	ALL COLORS*
HPC-8699	WASHER	-	1/4	M10	WHITE ONLY
HPC-8712	CAP	0.357	5/16	M12	ALL COLORS*
HPC-8799	WASHER	-	5/16	M12	WHITE ONLY

* See Color Selection Chart below.

SPECIFICATIONS

- Standard Material: Polypropylene with U.V. Stabilizer
- Consult factory for availability of non-stock colors, custom or metric sizes; minimum order requirements may apply

HPC Series

The HPC Series of Decorative Caps is interchangeable with our LPC Series; with one difference – a deeper cavity.

* These colors may not be available from stock; minimum order quantity is 10,000. A color matching service is available; minimum order quantity is 10,000 and a one-off matching fee is charged. Printing limitations may prevent exact color representation.



STANDARD COLORS	00	12*	61*	52*	41*
	White	Hot Canary Yellow	Damask	Wood Blue	Menwall Green
	06	15	35*	50*	47
	Off White	Gold	Ley Fawn	Smith Blue	Ley Green
	03	17*	30*	51	70
	Antique White	Tan	Mahogany	Royal Blue	Morning Grey
	05*	28	29	49*	71
	Parchment	Honey-maple	Teak	Squadron Blue	Pantone Grey
	10	65*	33	54*	74
	Stone	Cinnamon	Sandalwood	Ley Blue	Osprey
04	66	68	55*	72	
Fawn	Orange	Midland Brown	Clipper Blue	Silver Grey	
21	60	36	39*	73*	
Driftwood	Smith Red	Brushwood	Sea Green	Flint	
22	64*	69	42*	80	
Putty	Pillar Box Red	Ley Brown	Olive Green	Black	
				81	
				Stainless Steel	
				82	
				Silver	
				83	
				Gold	