

SHELF HARDWARE



PART NUMBER	A	B	C	D	E	F	MATERIAL	COLOR
169HE-1080-0000	0.234"	7/16"	1/2"	35/64"	1-1/16"	5/16"	POLYSTYRENE	BEIGE
169HE-1083-0000	1/4"	1/4"	1/2"	35/64"	7/8"	5/16"	POLYSTYRENE	BEIGE

SPECIFICATIONS

- Standard Color: Beige
- Standard Material: Polystyrene

169 Series

Heavy Duty Shelf Supports are designed for heavy loads and will provide years of economical support.

HEAVY DUTY SHELF SUPPORTS

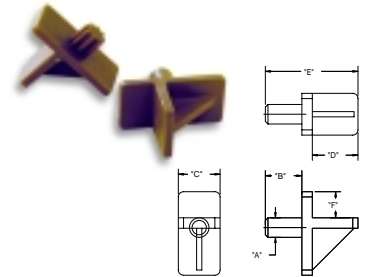

PART NUMBER	A	B	C	D	E	F	MATERIAL	COLOR
169BN-1061-0000	0.234"	11/32"	1/2"	29/64"	27/32"	3/16"	BUTYRATE	CLEAR
169BN-1070-0000	0.250"	13/32"	1/2"	29/64"	29/32"	1/4"	BUTYRATE	CLEAR

SPECIFICATIONS

- Standard Color: Clear
- Standard Material: Butyrate

169 Series

Light Duty Shelf Supports are designed to accommodate light to medium shelf loads. Manufactured from clear butyrate, these supports are durable and attractive, and can be used in a wide range of shelf configurations.

LIGHT DUTY SHELF SUPPORTS

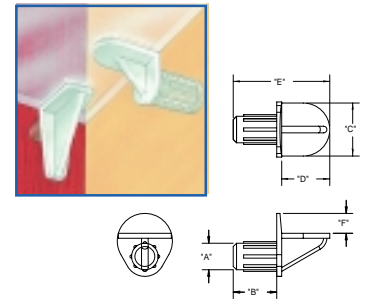

PART NUMBER	BRACKET THICKNESS	MATERIAL	COLOR
169BN-1100-0000	0.093"	BUTYRATE	CLEAR

SPECIFICATIONS

- Standard Color: Clear
- Standard Material: Butyrate

169 Series

Glass Shelf Supports clamp on easily to metal brackets. Manufactured from butyrate, shelf supports are glasslike in appearance, as well as stress and impact resistant.

GLASS SHELF SUPPORTS

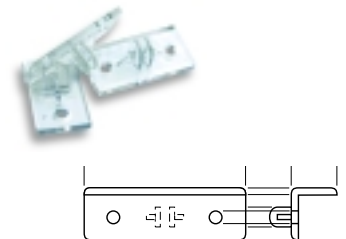

PART NUMBER	DESCRIPTION	MATERIAL	COLOR
350-0076	1.230 X .765 GLASS CLIP	NYLON	NATURAL
350-0075	1.250 X .750 GLASS CLIP	NYLON	NATURAL
350-0265	1.500 X 1.750 GLASS CLIP	NYLON	NATURAL
350-0385	1.575 X .760 GLASS CLIP	NYLON	NATURAL
350-0077	4.525 X 1.775 LARGE SIGN CLIP	NYLON	NATURAL
350-0182	1.020 X .710 SIGN CLIP	NYLON	NATURAL
350-0119	3.400 X .740 SIGN CLIP	NYLON	NATURAL
350-0151	0.705 X .580 CHANNEL	NYLON	NATURAL
350-0156	0.830 X .405 SUPPORT CLIP	NYLON	NATURAL
350-0157	0.835 X .405 SUPPORT CLIP	NYLON	NATURAL
350-0253	1.550 X .815 GLASS SHELF SUPPORT	NYLON	NATURAL

SPECIFICATIONS

- Standard Color: Natural
- Standard Material: Nylon
- Optional Materials: K-resin, Butyrate, ABS

350 Series

GLASS CLIPS



SHELF HARDWARE

RETAINER CLIPS



PART NUMBER	PANEL THICKNESS	MATERIAL	COLOR
169NN-6010-0000	0.156"	NYLON	NATURAL

SPECIFICATIONS

- *Standard Color:* Natural
- *Standard Material:* Nylon

169Series

Retainer Clips are an excellent way of retaining panels or screens to an opening in a door. Manufactured from durable nylon, Retainer Clips are an attractive yet economical method of securing a mirror to a wall or as a means of mounting a picture into a frame.

CLIPS FOR METAL TUBING

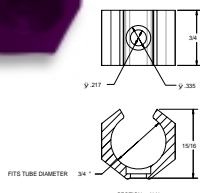

PART NUMBER	MATERIAL	COLOR
169PB-6520-0000	POLYETHYLENE	BLACK

SPECIFICATIONS

- *Standard Color:* Black
- *Standard Material:* Polyethylene

169Series

Alliance Plastics' TV Tray Clips are ideal for securing trays to metal tubing and other applications where tubing requires clip-fastening.

PLASTIC DOWEL PINS

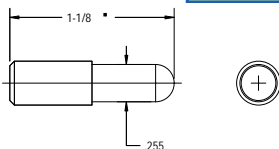

PART NUMBER	MATERIAL	COLOR
169LN-9020-0000	LINEAR POLYETHYLENE	WHITE

SPECIFICATIONS

- *Standard Color:* White
- *Standard Material:* Linear Polyethylene

169SERIES

Used as an extension-style leaf tables, this durable plastic pin replaces the traditional wood dowel. Unlike wood, plastic dowels will not expand or contract, and will not warp or loosen. Also, plastic will not chip the leading edge of laminates when leaf is placed into position.

CLOSET POLE HANGERS



PART NUMBER	MATERIAL	COLOR
169HW-7010-0000	POLYSTYRENE	WHITE

SPECIFICATIONS

- *Standard Color:* White
- *Standard Material:* Polystyrene
- *Fits pole size:* 1.406
- *Countersunk:* 0.185" Hole

169Series

Closet Pole Hangers are inexpensive alternatives to metal components and are durable enough to withstand heavy loads.